

# OBJEKTGARNITUR TASMANIA ER 31Q PROJECT LEVER SETS TASMANIA ER 31Q

EDLES AUS STAHL

DESIGNS OF STAINLESS STEEL



**KARCHER**  
DESIGN

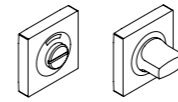

**EZ 1343 BAD**  
Badverriegelung  
mit rot/weiss  
Verriegelung

**EZ 1343 BAD**  
Turn and release  
with red and white  
indicator

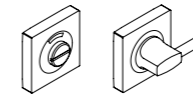

**EZ 1344 BAD**  
Behindertengerechte  
Badverriegelung  
mit rot/weiss  
Verriegelung

**EZ 1344 BAD**  
Turn and release  
with red and white  
indicator for disabled

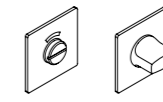

**EZ 181Q BAD**  
PLAN DESIGN  
Badverriegelung  
mit rot/weiss

**EZ 181Q BAD**  
PLAN DESIGN  
turn and release  
with red and white  
indicator

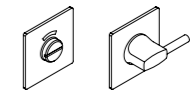

**EZ 182Q BAD**  
PLAN DESIGN  
Behindertengerechte  
Badverriegelung  
mit rot/weiss

**EZ 182Q BAD**  
PLAN DESIGN  
turn and release  
with red and white  
indicator for disabled

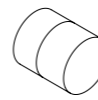

**EZ 209**  
Wandtürstopper

**EZ 209**  
Wall door stop

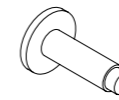

**EZ 210**  
Wandtürstopper

**EZ 210**  
Wall door stop

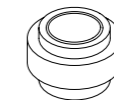

**EZ 211**  
Bodentürstopper

**EZ 211**  
Floor door stop

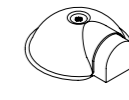

**EZ 215**  
Bodentürstopper

**EZ 215**  
Floor door stop

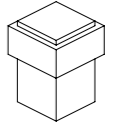

**EZ 216**  
Bodentürstopper

**EZ 216**  
Floor door stop

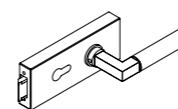

**EGS 370 - ED 31**  
Ausführung:  
UN, PZ, BB, BAD

**EGS 370 - ED 31**  
Options:  
UN, PZ, BB, BAD

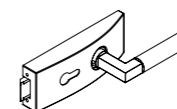

**EGS 350 - ED 31**  
Ausführung:  
UN, PZ, BB, BAD

**EGS 350 - ED 31**  
Options:  
UN, PZ, BB, BAD

Für die hier gezeigte Produktfamilie TASMANIA ER 31Q gibt es weitere ausführliche Informationen in unserem aktuellen Produktkatalog. Ausschreibungstexte für jedes Produkt sind erhältlich auf unserer Homepage unter [www.karcher-design.de](http://www.karcher-design.de) oder bei Karcher GmbH direkt. Bei weiteren Fragen wenden Sie sich bitte an unser Verkaufsteam das Ihnen gerne behilflich ist.

More detailed information about the TASMANIA ER 31Q productfamily can be found in our latest catalogue. In addition specification details and product drawings can be found on our webpage under [www.karcher-design.co.uk](http://www.karcher-design.co.uk). For further support please contact our specification team who will be pleased to assist you.

**KARCHER**  
DESIGN

Karcher GmbH  
Raiffeisenstraße 32  
74906 Bad Rappenau  
Tel.: +49/72 64/91 64-0  
Fax: +49/72 64/91 64-40  
[mail@karcher-design.de](mailto:mail@karcher-design.de)  
[www.karcher-design.de](http://www.karcher-design.de)

**Produktfamilie:**  
**Tasmania ER 31Q /**  
**EPL 31Q**  
**Edelstahl matt**

**Product family:**  
**Tasmania ER 31Q /**  
**EPL 31Q**  
**Satin Stainless Steel**

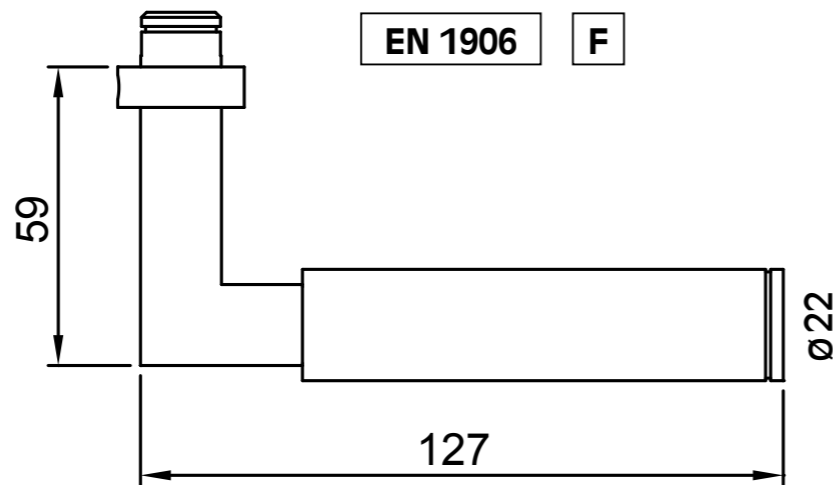

ER 31Q fest drehbar gelagert mit Hochhaltefeder und horizontaler Drückerruhestellung.  
 EPL 31Q Plan Design-Rosette drehbar gelagert. Unsichtbare, durchgehende Schraubverbindung.

Lever handle ER 31Q spring loaded with permanent connection to solid mounting plate.  
 Lever handle EPL 31Q Plan Design rose with back to back fixing.

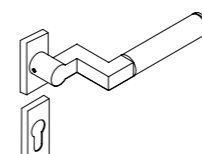
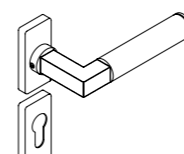
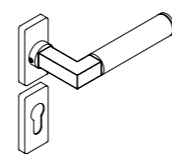
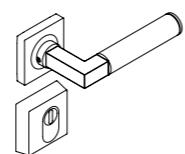
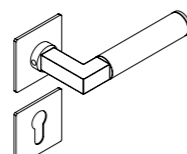
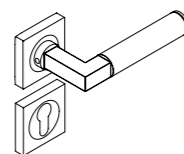

**Rosettengarnituren**

Geprüft nach DIN EN 1906  
 Gebrauchskategorie GK3 (ER 31Q und EPL 31Q) oder GK4 (ER/EN 31Q)  
 Feuerschutz-Garnitur nach DIN 18273 (ER/FS 31Q und EPL/FS 31Q)

**ER 31Q**  
**ER/EN 31Q**  
**ER/FS 31Q**  
 Ausführungen:  
 PZ, WG, BAD, BB, OS

**EPL 31Q**  
**EPL/FS 31Q**  
 Ausführungen:  
 PZ, WG, BAD, BB, OS

**ER 31Q**  
**ER/EN 31Q**  
**ER/FS 31Q**  
 mit Schutzrosette  
 ESR 300 KS oder  
 ESR 332 PZ

**ER 31Q RM**  
**ER/FS 31Q RM**  
 Ausführungen:  
 PZ, WG, OS

**ER 31Q RMG**  
**ER/FS 31Q RMG**  
 Ausführungen:  
 PZ, WG, OS

**ER 31Q RMG**  
**ER/FS 31Q RMG**  
 mit Schutzrosette  
 ESO 210 K oder  
 ESO 210 PZ

**Handle sets on rose**

Tested according to EN 1906 Category of use 3 (ER 31Q and EPL 31Q) or 4 (ER/EN 31Q) Fire resistant handle sets tested after EN 18273 (ER/FS 31Q and EPL/FS 31Q)

**ER 31Q**  
**ER/EN 31Q**  
**ER/FS 31Q**  
 Options:  
 latch, keyhole, euro profile, turn/release

**EPL 31Q**  
**EPL/FS 31Q**  
 Options:  
 latch, keyhole, euro profile, turn/release

**ER 31Q**  
**ER/EN 31Q**  
**ER/FS 31Q**  
 including security escutcheon  
 ESR 300 KS or  
 ESR 332 PZ

**ER 31Q RM**  
**ER/FS 31Q RM**  
 Options:  
 latch, euro profile

**ER 31Q RMG**  
**ER/FS 31Q RMG**  
 Options:  
 latch, euro profile

**ER 31Q RMG**  
**ER/FS 31Q RMG**  
 including security escutcheon  
 ESO 210 K or  
 ESO 210 PZ

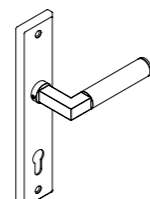
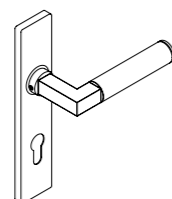

**Langschildgarnituren**

Mit durchgehender Schraubverbindung (ELXQ 31 und RLE 31) und als Feuerschutzgarnitur nach DIN 18273 (EL/FS 31Q und RLE/FS 31Q)

**ELXQ 31**  
**ELXQ/FS 31**  
 Ausführungen:  
 PZ, WG, BAD, BB

**RLE 31**  
**RLE/FS 31**  
 Ausführungen:  
 PZ, WG, BAD, BB

**Schutzgarnituren**  
 Geprüft nach DIN EN 1906 Einbruchssicherheit 2 oder 4 und nach DIN 18257 ES1 oder ES3 Feuerschutzgarnitur nach DIN 18273 (nur ESG31 675/685)

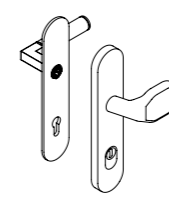
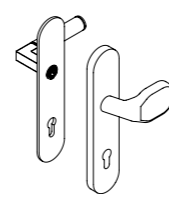
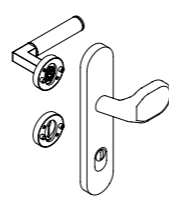

**ESGR 31 K 670**  
 Ausführungen:  
 Profilzylinder  
 70, 72, 88, 92 mm

**ESG 31 675**  
 Ausführungen:  
 Profilzylinder  
 70, 72, 88, 92 mm

**ESG 31 675 K /**  
**ESG 31 685 K**  
 Ausführungen:  
 PZ 72, PZ 88, PZ 92 mit Kernziehschutz

**Lever handles on plates**

ELXQ 31 and RLE 31 with M5 bolt through fixing for heavy duty use and fire resistance according to DIN 18273 (EL/FS 31Q and RLE/FS 31Q)

**ELXQ 31**  
**ELXQ/FS 31**  
 Options:  
 latch, keyhole, euro profile, turn/release

**RLE 31**  
**RLE/FS 31**  
 Options:  
 latch, keyhole, euro profile, turn/release

**Security lever sets**  
 Tested according to EN 1906 security class 2 or 4 Fire resistants tested according to EN 18273 (only ESG31 675/685)

**ESGR 31 K 670**  
 Options:  
 Euro profile  
 70, 72, 88, 92 mm

**ESG 31 675**  
 Options:  
 Euro profile  
 70, 72, 88, 92 mm

**ESG 31 675 K /**  
**ESG 31 685 K**  
 Options:  
 Euro profile 72, 88, 92 mm, including cylinder protection

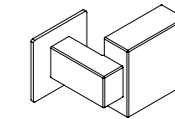
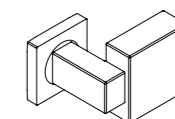

**Knöpfe**  
 für Wechselgrt. getestet nach DIN EN 1906 Gebrauchskategorie GK3 oder GK4

**EK 550 GRO**  
 gekröpfter Knopf  
 Ausführungen:  
 drehbar oder fest

**EPLK 550 GRO**  
 gekröpfter Knopf  
 Ausführungen:  
 drehbar oder fest

**Knobs**  
 Tested according to EN 1906 category of use 3 or 4 including screw spindle

**EK 550 GRO**  
 offset knob furniture  
 Options:  
 fixed or operational

**EPLK 550 GRO**  
 offset knob furniture  
 Options:  
 fixed or operational

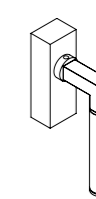
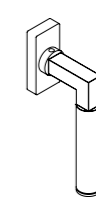

**Fenstergriffe**

**EF 314Q**  
 4-fach Rasterung

**EF 314Q**  
 4-fach Rasterung mit abschließbarem Gehäuse EAR400Q

**Window handles**

**EF 314Q**  
 Tilt and turn mechanism

**EF 314Q**  
 Tilt and turn mechanism including lockable window rose EAR400Q



**Stoßgriffe**

Befestigungsausführungen: Paarweise, unsichtbar und durchgehende Einzelbefestigung

**ES 31**  
 gerade  
 Achsmaß:  
 300, 400

**ES 31 G**  
 gerade  
 Achsmaß:  
 300, 400

**Pull handles**

Fixing options: Back to back, bolt through and face fixing

**ES 31**  
 straight  
 Fixing Centre:  
 300, 400

**ES 31 G**  
 straight  
 Fixing Centre:  
 300, 400